

VECO®
JAPAN



HANDLE

VECO ORIGINAL HARDWARE

HANDLE

No.550



Finish / ផ្ទៃ :



SSHL

Dimension

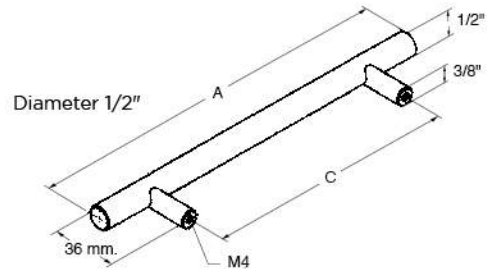
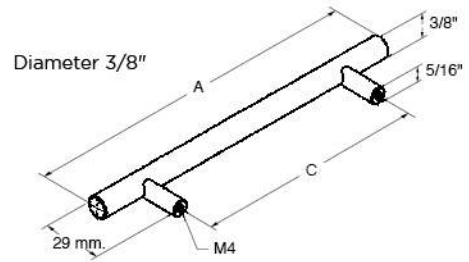

Description ឧបករណ៍	Size ទំហំ	Material ធាតុ
NO.550 Diameter 3/8"	A136mm X C96mm	Stainless Steel SUS 304 ស្តេនឡេស៊ី 304
	A168mm X C128mm	
	A200mm X C160mm	
	A232mm X C192mm	
	A328mm X C288mm	
	A392mm X C352mm	
	A488mm X C448mm	

Description ឧបករណ៍	Size ទំហំ	Material ធាតុ
NO.550 Diameter 1/2"	A136mm X C96mm	Stainless Steel SUS 304 ស្តេនឡេស៊ី 304
	A168mm X C128mm	
	A200mm X C160mm	
	A232mm X C192mm	
	A328mm X C288mm	
	A392mm X C352mm	
	A488mm X C448mm	

AUD-3212



Dimension

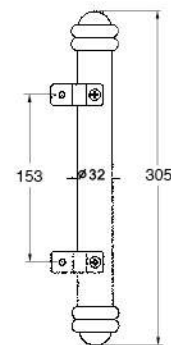

Description ឧបករណ៍	Size ទំហំ	Material ធាតុ
AUD-3212	305mm. X 153mm.	Stainless Steel SUS 304 ស្តេនឡេស៊ី 304

Finish / ផ្ទៃ :



SSHL-N

SSHL-PB

HANDLE

Brass 23



Dimension

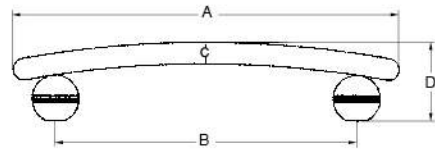

Description รุ่น	Size / ขนาด				Material วัสดุ
	A	B	C	D	
Brass23-96	132	96	7	29	Brass / ทองเหลือง
Brass23-128	164	128	9	36	Brass / ทองเหลือง

Finish / สี :



Brass 24



Dimension

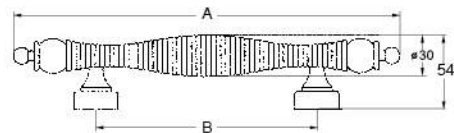

Description รุ่น	Size / ขนาด		Material วัสดุ
	A	B	
Brass 24A, W	280	160	Brass / ทองเหลือง

Finish / สี :



A = for glass and wooden door
 W = for wooden door
 ขา A = สำหรับประตูกระจกและประตูไม้
 ขา W = สำหรับประตูไม้

Brass 25



Dimension

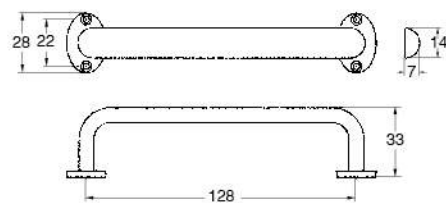

Description รุ่น	Size ขนาด	Material วัสดุ
Brass 25	128 mm.	Brass / ทองเหลือง

Finish / สี :



HANDLE

C5038



Dimension

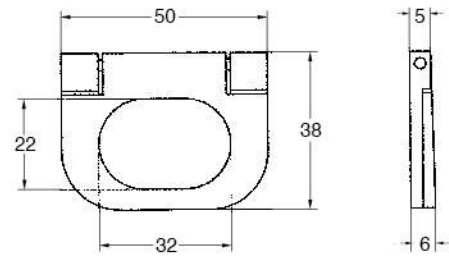

Description ຮູບ	Size ໝາດ	Material ວັສຸດ
C5038	50mm. X 38mm.	Zinc Alloy No.3 ຮິງຄີວັສລອຍເນວຣ໌ 3

Finish / ຜ້ :



CDH115



Dimension

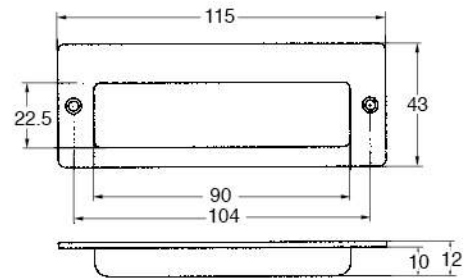

Description ຮູບ	Size ໝາດ	Material ວັສຸດ	Finish ຜ້
CDH115	155mm. X 43mm.	Steel / ເຫຼັກ	AB, AC
		Stainless Steel SUS 304 ສະເຕນເລດສ໌ 304	SSHL, SSLH-B
		Brass / ພຽງເຮືອງ	PB

Finish / ຜ້ :



HANDLE

CDK63/1, CDK63/2, CDK63/3



CDK63/1



CDK63/2



CDK63/3

Dimension

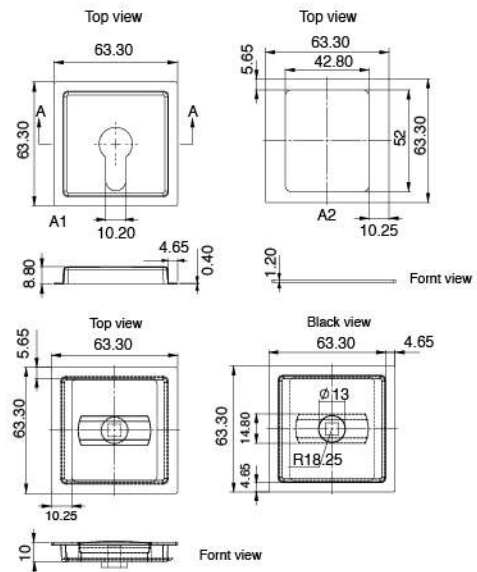

Description ຊື່	Size / ມາດ		Material ວັດຖຸ
	A	B	
CDK63/1	63.30	8.80	Stainless Steel SUS 304 ສະຕິນເລສຕິນ 304
CDK63/2	63.30	8.80	
CDK63/3	63.30	8.80	

Finish / ຜ້ :

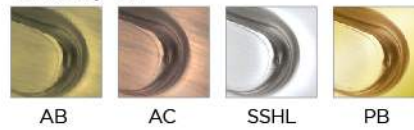

CDL127



Dimension

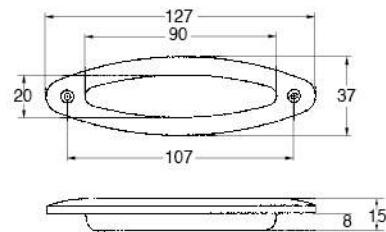

Description ຊື່	Size ມາດ	Material ວັດຖຸ	Finish ຜ້
CDL127	127mm. X 37mm.	Steel / ເຫິນ	AB, AC
		Stainless Steel SUS 304 ສະຕິນເລສຕິນ 304	SSLH, SSLH-B
		Brass / ຫຸ້ນເສັ້ນ	PB, B-HL

Finish / ຜ້ :



HANDLE

CDQ



Dimension

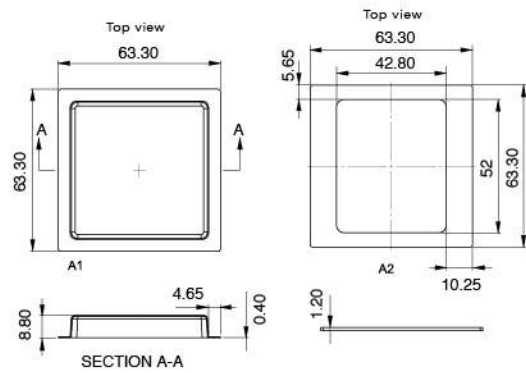

Description ຊື່	Size / ທາດ		Material ໄຊຊ
	A	B	
CDQ	63.30	8.80	Stainless Steel SUS 304 ສະຕິນເລດ 304

Finish / ຜ້ :



AB

AC

SSHL

PB

CDP

Dimension

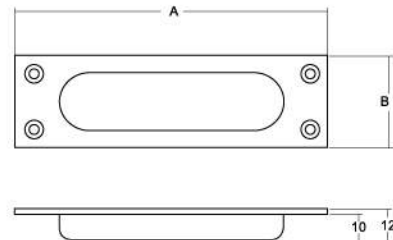

Description ຊື່	Size / ທາດ		Material ໄຊຊ	Finish ຜ້
	A	B		
CDP	120mm.	35mm.	Steel / ເຫຼັກ	AB, AC
	180mm.	60mm.	Stainless Steel SUS 304 ສະຕິນເລດ 304	SSHL, SSSL-B
			Brass / ພຽງເສັ້ນ	PB, B-HL

Finish / ຜ້ :



AB

AC

SSHL

SSHL-B

PB

B-HL

HANDLE

CDP 717



Dimension

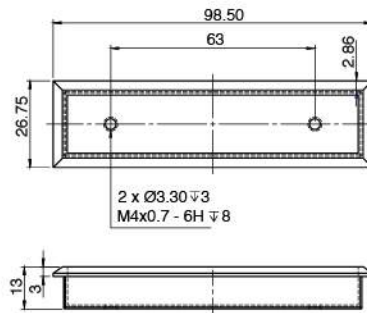

Description ຊື່	Material ໂລຫະ
CDP 717	Stainless Steel SUS 304 ສະເຕນເລສ 304

Finish / ຜ້າ :



AB

AC

SSHL

PB

CDR

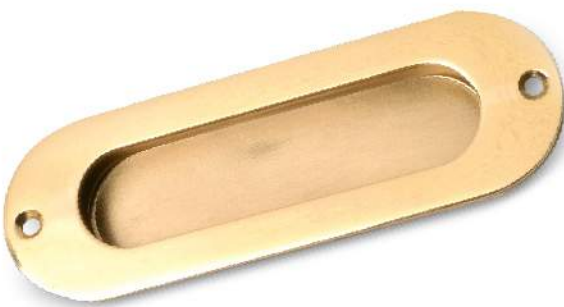

Dimension

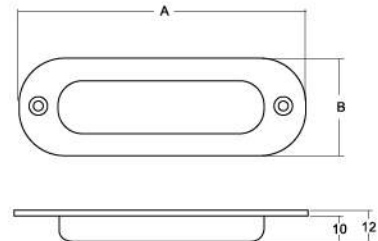

Description ຊື່	Size / ບາດ		Material ໂລຫະ	Finish ຜ້າ
	A	B		
CDR	120mm.	40.5mm.	Steel / ເຫຼັກ	AB, AC
	175mm.	60mm.	Stainless Steel SUS 304 ສະເຕນເລສ 304	SSHL, SSHL-B
			Brass / ທອງເສັ້ນ	PB, B-HL

Finish / ຜ້າ :



AB

AC

SSHL

SSHL-B

PB

B-HL

HANDLE

CP



Dimension

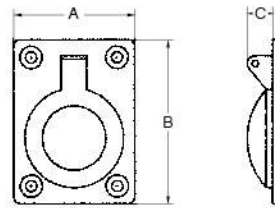

Description ຊື່	Size/ໝາກ			Material ວັດຖຸ	Finish ສີ
	A	B	C		
CP40	31	41	8	Zinc Alloy No.3 ຮິງຄີອັລລອຍເນວຣ໌ 3	AB, AC, HLNI, PB, G
CP50	38	51	10	Zinc Alloy No.3 ຮິງຄີອັລລອຍເນວຣ໌ 3	AB, AC, HLNI, PB, G
CP60	44	63	8	Stainless Steel SUS 304 ສະເຕນເລສເຕນ 304	SS-HL

Finish / ສີ :



D1722



Dimension

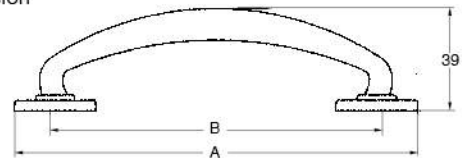

Description ຊື່	Size/ໝາກ		Material ວັດຖຸ
	A	B	
D1722	156	128	Zinc Alloy No.3 / ຮິງຄີອັລລອຍເນວຣ໌ 3

Finish / ສີ :



D3322



Dimension

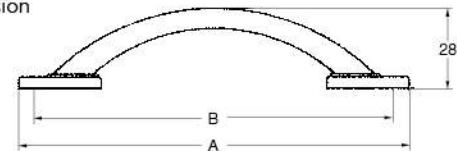

Description ຊື່	Size/ໝາກ		Material ວັດຖຸ
	A	B	
D3322	137	126	Zinc Alloy No.3 / ຮິງຄີອັລລອຍເນວຣ໌ 3

Finish / ສີ :



HANDLE

DJ0021



Dimension

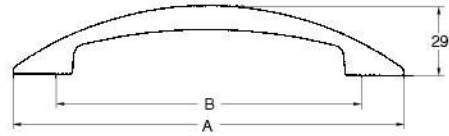

Description ຊື່	Size/ໜາ		Material ວັດຖຸ
	A	B	
DJ0021	164	128	Zinc Alloy No.3 / ສິ່ງຄ້ວີລລອຍເນອຣ໌ 3

Finish / ຜ້ :



DJ0021A



Dimension

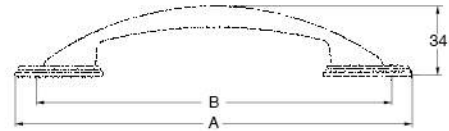

Description ຊື່	Size/ໜາ		Material ວັດຖຸ
	A	B	
DJ0021A	193	173	Zinc Alloy No.3 / ສິ່ງຄ້ວີລລອຍເນອຣ໌ 3

Finish / ຜ້ :

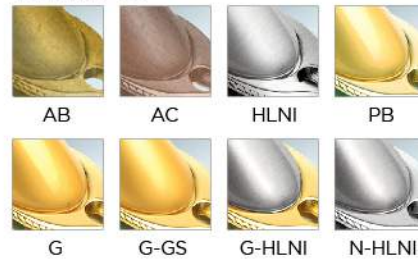

DJ0058 , DJ0059



Dimension

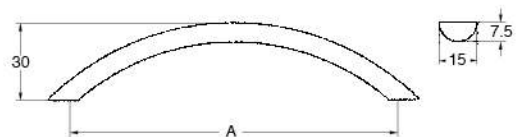

Description ຊື່	Size (A)	Material ວັດຖຸ
	ໜາ (A)	
DJ0058	96mm.	Zinc Alloy No.3 / ສິ່ງຄ້ວີລລອຍເນອຣ໌ 3
DJ0059	128mm.	Zinc Alloy No.3 / ສິ່ງຄ້ວີລລອຍເນອຣ໌ 3

Finish / ຜ້ :



HANDLE

DJ0086, DJ0088



Dimension

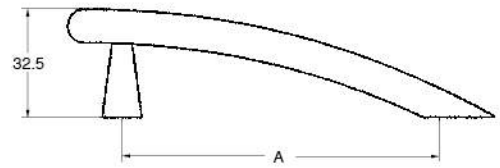

Description รุ่น	Size (A) ขนาด (A)	Material วัสดุ
DJ0086	96mm.	Brass / ทองเหลือง
DJ0088	224mm.	Brass / ทองเหลือง

Finish / ำ :



LH15



Dimension

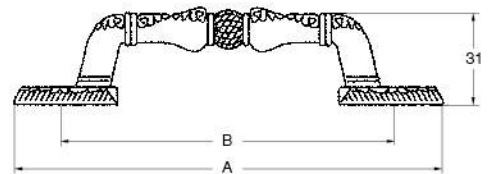

Description รุ่น	Size/ขนาด		Material วัสดุ
	A	B	
LH15	145	113	Zinc Alloy No.3 / ซิงค์อัลลอยเบอร์ 3

Finish / ำ :

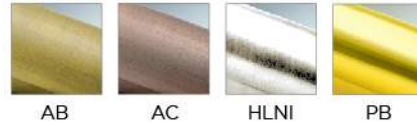

LHS11-110



Dimension

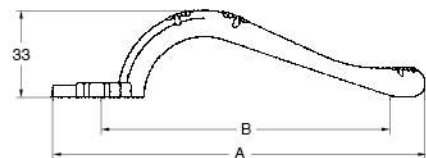

Description รุ่น	Size/ขนาด		Material วัสดุ
	A	B	
LHS11-110	142	110	Zinc Alloy No.3 / ซิงค์อัลลอยเบอร์ 3

Finish / ำ :



HANDLE

LHS11-137



Dimension

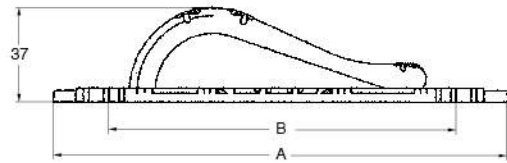

Description ຊື່	Size/ໜາ		Material ວັດຖຸ
	A	B	
LHS11-137	179	137	Zinc Alloy No.3 / ສິ່ງຄົວໂລອຍເນວ 3

Finish / ຜ້ :



MHZ13



Dimension

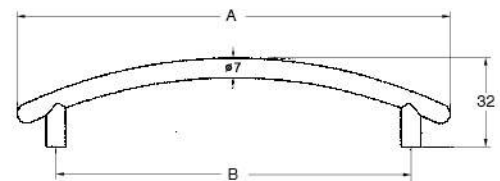

Description ຊື່	Size/ໜາ		Material ວັດຖຸ
	A	B	
MHZ13	156	128	Zinc Alloy No.3 / ສິ່ງຄົວໂລອຍເນວ 3

Finish / ຜ້ :



MHZ13L



Dimension

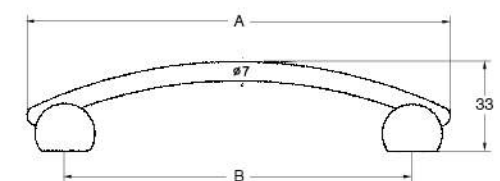

Description ຊື່	Size/ໜາ		Material ວັດຖຸ
	A	B	
MHZ13L	156	128	Zinc Alloy No.3 / ສິ່ງຄົວໂລອຍເນວ 3

Finish / ຜ້ :

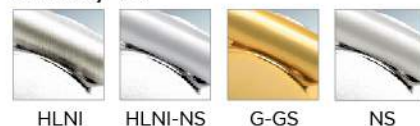

HANDLE

MHZ18



Dimension

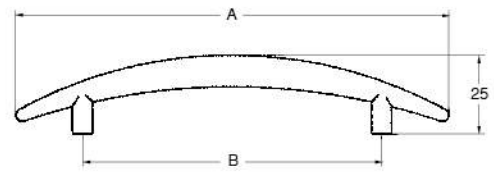

Description ຊື່	Size/ໝາກ		Material ໝາກ
	A	B	
MHZ18	139	96	Zinc Alloy No.3 / ອັດຕະໂນລອຍເບຣັດ 3
	185	128	

Finish / ຜ້ :

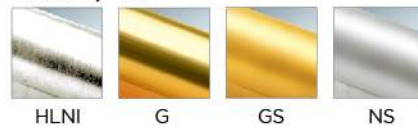

MS33



Dimension

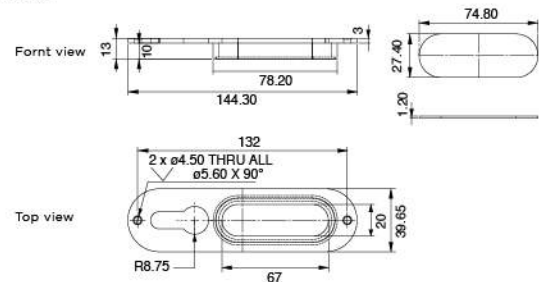

Finish / ຜ້ :



SSHL

Description ຊື່	Size/ໝາກ		Material ໝາກ
	A	B	
MS33	144.30	132	Stainless Steel SUS 304 ສະໂຕນເສັດ 304

No.1



Dimension

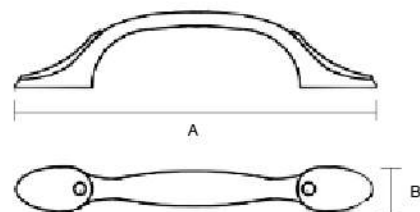

Finish / ຜ້ :



SSHL

Description ຊື່	Material ໝາກ
No.1	Steel / ເຫຼັກ

HANDLE

No.1101



A = for glass and wooden door
 W = for wooden door
 ขา A = สำหรับประตูกระจกและประตูไม้
 ขา W = สำหรับประตูไม้

Dimension

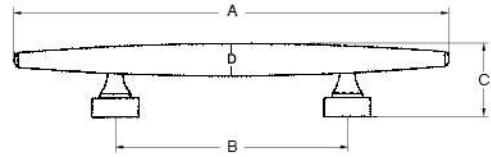

Description รุ่น	Size / ขนาด				Material วัสดุ
	A	B	C	D	
NO.1101A	250	128	50	20	Brass / ทองเหลือง
	300	160	52	22	
	650	400	62	25	
NO.1101W	250	128	50	20	Brass / ทองเหลือง
	300	160	52	22	

Finish / สี :



No.22



Dimension

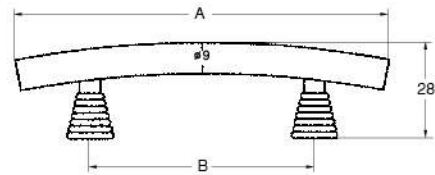

Description รุ่น	Size/ขนาด		Material วัสดุ
	A	B	
NO.22	106	64	Zinc Alloy No.3 / อิงค์อัลลอยเบอร์ 3
	142	96	

Finish / สี :



No.25230 No.25260 No.25356



A = for glass and wooden door
 W = for wooden door
 ขา A = สำหรับประตูกระจกและประตูไม้
 ขา W = สำหรับประตูไม้

Dimension

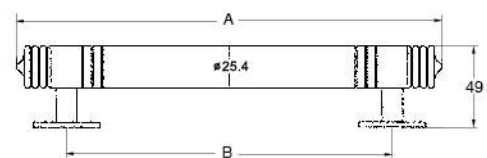

Description รุ่น	Size/ขนาด		Material วัสดุ
	A	B	
NO.25230A, W	230	163	Stainless Steel SUS 304 สแตนเลสเกรด 304
NO.25260A, W	260	199	
NO.25356A, W	356	295	

Finish / สี :



HANDLE

No.319



Dimension

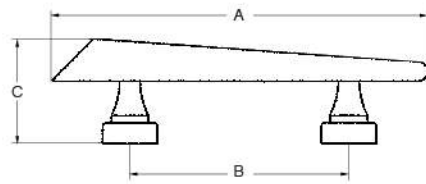

Description รุ่น	Size/ขนาด			Material วัสดุ
	A	B	C	
No.319A, W	110	64	27	Brass / ทองเหลือง
	145	96	27	
	250	130	53	
	300	160	53	

A = for glass and wooden door
 W = for wooden door
 ขา A = สำหรับประตูกระจกและประตูไม้
 ขา W = สำหรับประตูไม้

Finish / สี :



No.656



Dimension

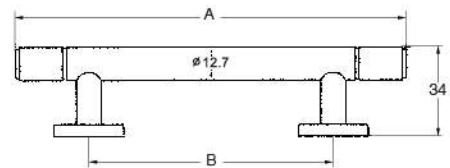

Description รุ่น	Size/ขนาด		Material วัสดุ
	A	B	
No.656	150	95	Stainless Steel SUS 304 สแตนเลสเกรด 304
	200	126	
	300	225	
	375	296	
	450	368	
	500	398	
	600	502	

Finish / สี :



No.7700



Dimension

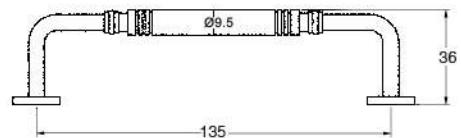

Description รุ่น	Size ขนาด	Material วัสดุ
No.7700	135mm.	Stainless Steel SUS 304 สแตนเลสเกรด 304

Finish / สี :



HANDLE

No.780



Dimension

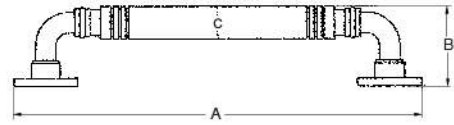

Description ຊື່	Size/ໝາດ			Material ໝາດ
	A	B	C	
No.780	135	32	12.7	Stainless Steel SUS 304 ສະຕິນເລສ໌ 304
	170	37	14	
	220	53	19	

Finish / ວິໄນ :



No.790



Dimension

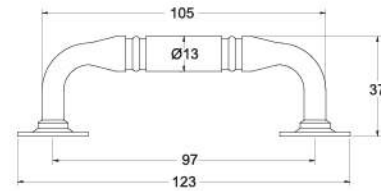

Description ຊື່	Size ໝາດ	Material ໝາດ
No.790	123mm.	Stainless Steel SUS 304 ສະຕິນເລສ໌ 304

Finish / ວິໄນ :



No.A6341



Dimension

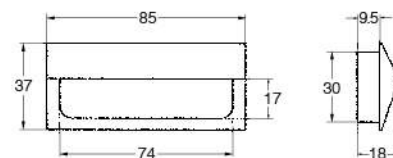

Description ຊື່	Size ໝາດ	Material ໝາດ
No.A6341	85mm. X 37mm.	Zinc Alloy No.3 ສິ່ງຄົ້ນຄວ້າເບຣັດ 3

Finish / ວິໄນ :

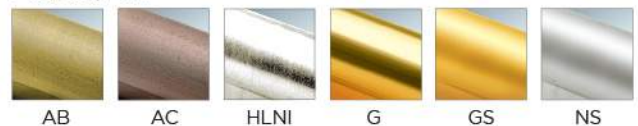

HANDLE

No.S1355



Dimension

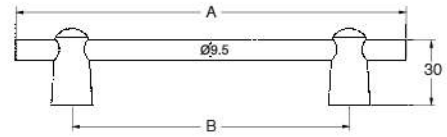

Description ຊື່	Size/ໝາກ		Material ໝາກ
	A	B	
NO. S1355	150	96	Stainless Steel SUS 304 ສະຕິນເລສຕິນ 304
	180	128	
	250	185	
	450	386	
	600	535	

Finish / ຜ້ :



SSHL

PHB1



Dimension

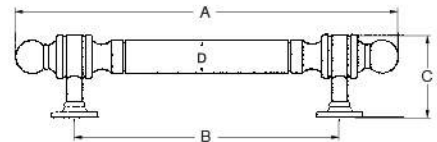

Description ຊື່	Size/ໝາກ				Material ໝາກ
	A	B	C	D	
PHB 1A, W	115	75	30	11.0	Brass / ນ່ວງເຮືອນ
PHB 1A, W	150	104	39	12.7	
PHB 1A, W	240	167	57	20.0	

Finish / ຜ້ :

A = for glass and wooden door
W = for wooden door
ຫ A = ສຳລັບປະຕູກະຈາກແລະປະຕູໄມ້
ຫ W = ສຳລັບປະຕູໄມ້



PHB2



Dimension

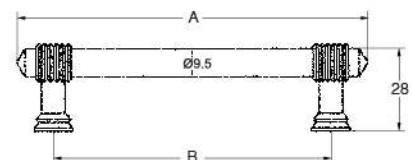

Description ຊື່	Size/ໝາກ		Material ໝາກ
	A	B	
PHB 2	100	75	Brass / ນ່ວງເຮືອນ
	120	95	

Finish / ຜ້ :



HANDLE

PHB5



PHB5W

PHB5W LOTUS 280 MM.

PHB5A LOTUS 420 MM.

- A = for glass and wooden door
- W = for wooden door
- AL = for aluminium door frame
- ข่า A = สำหรับประตูกระจกและประตูไม้
- ข่า W = สำหรับประตูไม้
- ข่า AL = สำหรับประตูอลูมิเนียม

Dimension

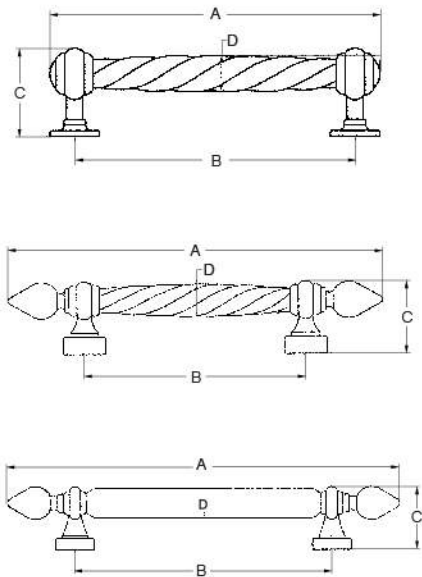

Description รุ่น	Size/ขนาด				Material วัสดุ
	A	B	C	D	
PHB5A, W	120	102	38	13	Brass ทองเหลือง
PHB5A, W	193	165	55	24	
PHB5A, W LOTUS	280	165	54	24	
PHB5A, W, AL LOTUS	420	275	67	32	

Finish / สี :



PHB6



Dimension

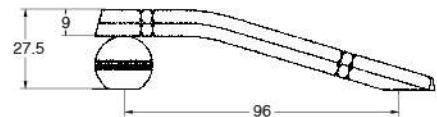

Description รุ่น	Size (A) ขนาด (A)	Material วัสดุ
PHB 6	96mm.	Brass / ทองเหลือง

Finish / สี :



HANDLE

PHB8



Dimension

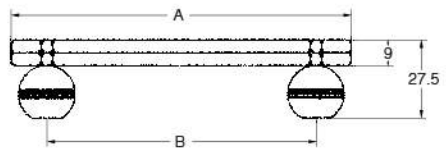

Description ຊື່	Size/ໝາດ		Material ວັດຖຸ
	A	B	
PHB8	120	95	Brass / ພອງເສື້ອ

Finish / ຜ້າ :



G G-B G-GS G-HLNI N-HLNI

PHB9



Dimension

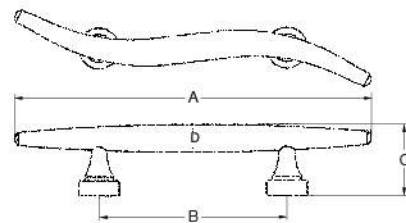

Description ຊື່	Size/ໝາດ				Material ວັດຖຸ
	A	B	C	D	
PHB9 A, W	140	74	26	11	Brass ພອງເສື້ອ
PHB9 A, W	300	170	50	20	
PHB9 A, W	650	400	62	25	

Finish / ຜ້າ :



AB AC HLNI G G-B G-GS G-HLNI N-HLNI

PHB10



Dimension

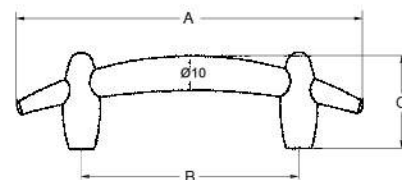

Description ຊື່	Size/ໝາດ			Material ວັດຖຸ
	A	B	C	
PHB10 A, W	100	64	27	Brass / ພອງເສື້ອ
	140	96	28	

Finish / ຜ້າ :



G GS G-B G-GS G-HLNI N-HLNI

HANDLE

PHB14



Finish / ำ :



SSHL

Dimension

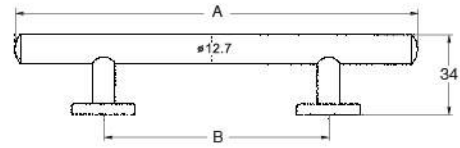

Description ขุ	Size/ขนาด		Material วัสดุ
	A	B	
PHB 14	135	96	Stainless Steel SUS 304 สแตนเลส 304
	167	128	
	233	160	
	267	192	
	363	288	
	427	352	
	523	448	
	1000	450	

PHB15



Dimension

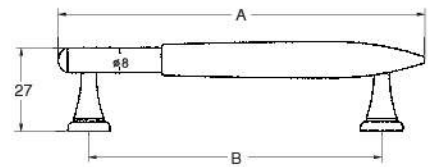

Description ขุ	Size/ขนาด		Material วัสดุ
	A	B	
PHB15	90	64	Brass / ทองเหลือง
	120	96	

Finish / ำ :



G-B

G-GS

G-HLNI

N-HLNI

PHB16



Dimension

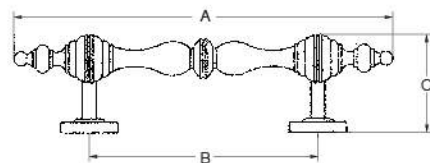

Description ขุ	Size/ขนาด			Material วัสดุ
	A	B	C	
PHB16 A, W	164	96	42	Steel / เหล็ก
	220	130	53	
	282	165	64	
	380	246	72	

Finish / ำ :



AB

AC

HLNI

PB

A = for glass and wooden door
W = for wooden door
ข A = สำหรับประตูกระจกและประตูไม้
ข W = สำหรับประตูไม้

HANDLE

PHC14



Dimension

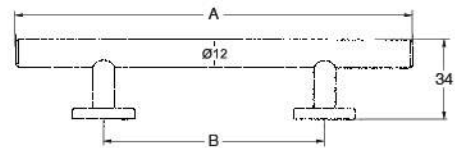

Description ຊື່	Size/ໜາວ		Material ໝາກ
	A	B	
PHC 14	135	96	Stainless Steel SUS 304 ສະຕິນເລດສ 304
	167	128	
	233	160	
	267	192	

Finish / ຜ້ :



SSHL

PSQ



Dimension

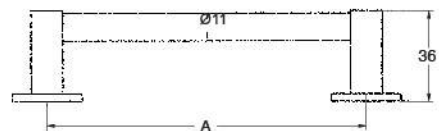

Description ຊື່	Size (A) ໜາວ (A)	Material ໝາກ
PSQ	128, 250mm.	Stainless Steel SUS 304 ສະຕິນເລດສ 304

Finish / ຜ້ :



SSHL

PSS



Dimension

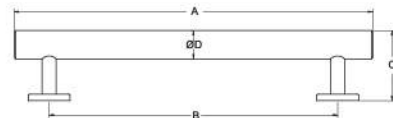

Description ຊື່	Size/ໜາວ				Material ໝາກ
	A	B	C	D	
PSS13150	150	98	36	13	Stainless Steel SUS 304 ສະຕິນເລດສ 304
PSS13200	200	150	36	13	
PSS19239	240	193	47	19	
PSS19239L (PSS19239 with line)	240	193	47	19	
PSS19280W LOTUS SSHL	280	193	47	19	
PSS19300	300	260	47	19	
PSS19300L	300	260	47	19	
PSS32500L	500	410	58	55	

Finish / ຜ້ :



AB

AC

SSHL

PB

HANDLE

PSU25280 , PSU25380 , PSU25420



Dimension

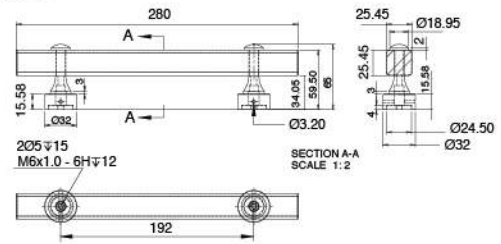

Description รุ่น	Size/ขนาด				Material วัสดุ
	A	B	C	D	
PSU25280	280	32	59.50	15.58	Stainless Steel SUS 304 สแตนเลสเกรด 304
PSU25380	380	32	59.50	15.58	
PSU25420	420	32	59.50	15.58	

Finish / ฝ้า :



SSHL

ZI-ALLO1



Dimension

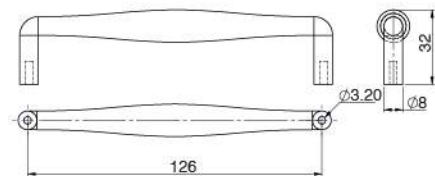

Description รุ่น	Material วัสดุ
ZI-ALLO1	Zinc Alloy No.3 ซิงค์อัลลอยเบอร์ 3

Finish / ฝ้า :



B

ZP101 , ZP102



Dimension

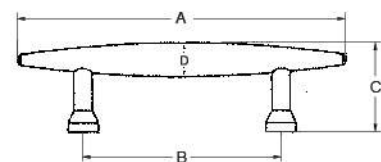

Description รุ่น	Size/ขนาด				Material วัสดุ
	A	B	C	D	
ZP101	142	96	27	10	Zinc Alloy No.3 ซิงค์อัลลอยเบอร์ 3
ZP102	109	65	29	11	

Finish / ฝ้า :

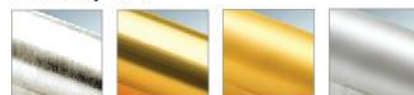

HLNI

G

GS

NS

HANDLE

ZP103 , ZP104



Dimension

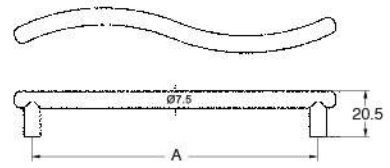

Description ຊື່	Size (A) ໝາດ (A)	Material ໄຊຕ
ZP103	128mm.	Zinc Alloy No.3 ຊິງຄີວິລລອຍເນວຣ໌ 3
ZP104	96mm.	

Finish / ວິສາ :

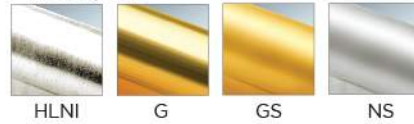

ZP134



Dimension

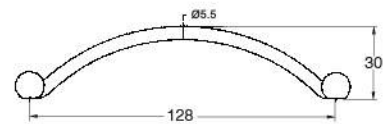

Description ຊື່	Size (A) ໝາດ (A)	Material ໄຊຕ
ZP134	128mm.	Zinc Alloy No.3 ຊິງຄີວິລລອຍເນວຣ໌ 3

Finish / ວິສາ :

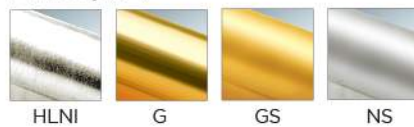

ZP224



Dimension

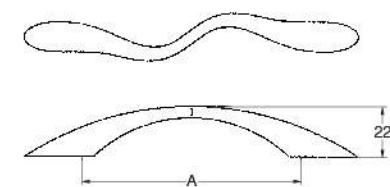

Description ຊື່	Size (A) ໝາດ (A)	Material ໄຊຕ
ZP224	64, 96mm.	Zinc Alloy No.3 ຊິງຄີວິລລອຍເນວຣ໌ 3

Finish / ວິສາ :

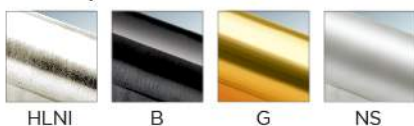

HANDLE

ZP317



Dimension

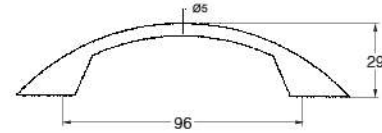

Description ຊື່	Size (A) ໝາດ (A)	Material ໄຊດ
ZP317	96mm.	Zinc Alloy No.3 ຮິງຄີອັລລອຍເນວຣ໌ 3

Finish / ຜ້ :



ZP9631



Dimension

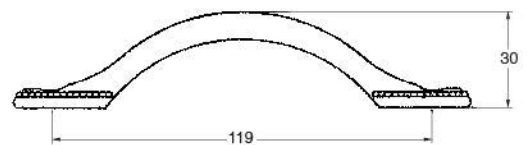

Description ຊື່	Size (A) ໝາດ (A)	Material ໄຊດ
ZP9631	96mm.	Zinc Alloy No.3 ຮິງຄີອັລລອຍເນວຣ໌ 3

Finish / ຜ້ :

