

VECO®
JAPAN

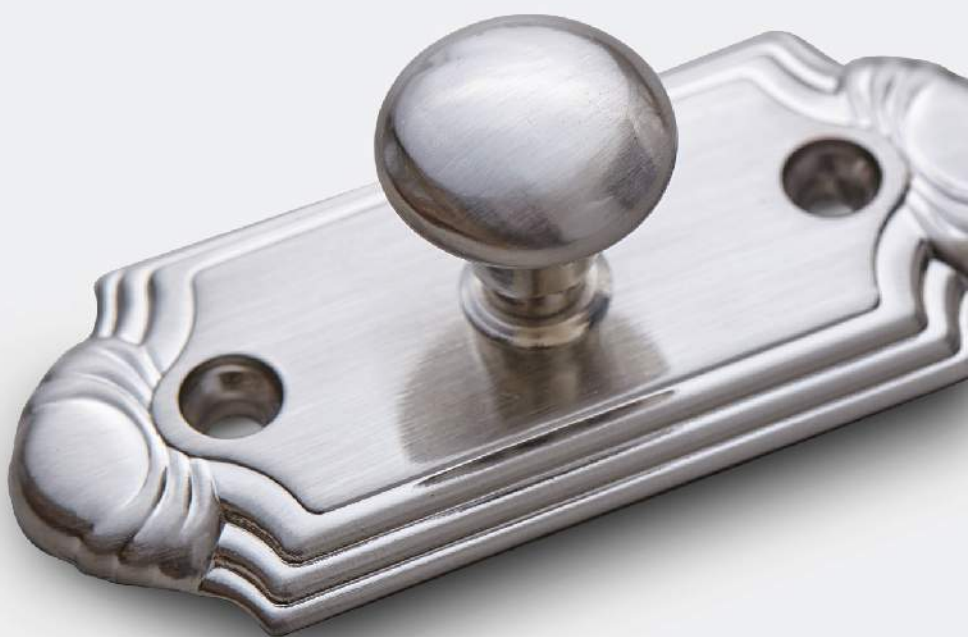

Knob **Mirror Screw**

VECO ORIGINAL HARDWARE

KNOB

BRASS 23K



Dimension

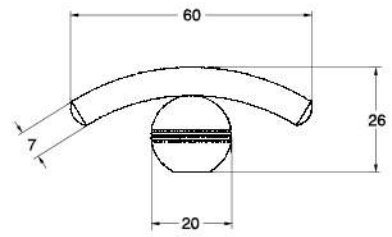

Description ຊື່	Size ຂະໜາດ	Material ວັດຖຸ
Brass 23K	60 mm.	Brass / ພອງເລື້ອງ

Finish / ັ້ :



G G-B G-GS G-HLNI N-HLNI

DJ0064



Dimension

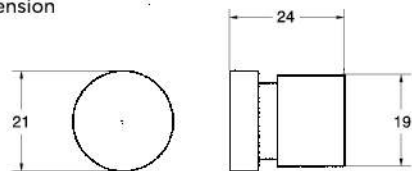

Description ຊື່	Material ວັດຖຸ
DJ0064	Stainless Steel SUS 304 / ທາດເສັດສະໜາ 304 Brass / ພອງເລື້ອງ Steel / ເຟັ້ກ

Finish / ັ້ :



AB HLNI C CS G GS N NS

DJ0065



Dimension

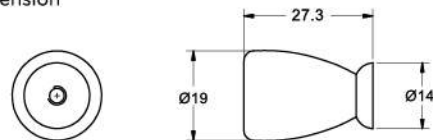

Description ຊື່	Material ວັດຖຸ
DJ0065	Stainless Steel SUS 304 / ທາດເສັດສະໜາ 304 Brass / ພອງເລື້ອງ Steel / ເຟັ້ກ

Finish / ັ້ :



AB HLNI C CS G GS N NS

KNOB

DJ0069



Dimension

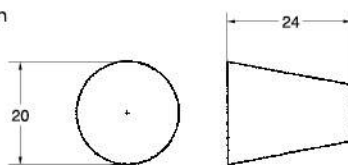

Description ຊື່	Material ວັດຖຸ
DJ0069	Stainless Steel SUS 304 / ສະແຕນເລສເຕດ 304 Brass / ກອງເລື່ອງ Steel / ເຟັ້ນ

Finish / ຜັ່ :



DJ0071



Dimension

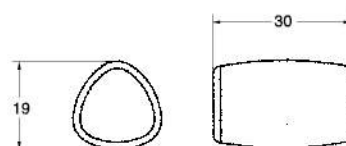

Description ຊື່	Material ວັດຖຸ
DJ0071	Zinc Alloy No.3 / ສິງຄ໌ອັລລອຍ ແນວ 3

Finish / ຜັ່ :

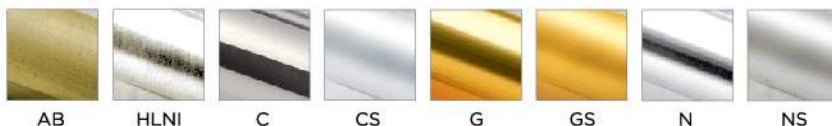

DJ0164



Dimension

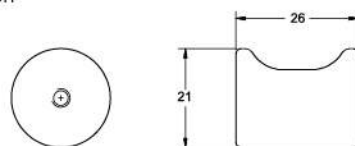

Description ຊື່	Material ວັດຖຸ
DJ0164	Stainless Steel SUS 304 / ສະແຕນເລສເຕດ 304 Brass / ກອງເລື່ອງ Steel / ເຟັ້ນ

Finish / ຜັ່ :

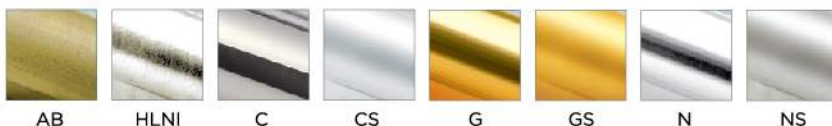

KNOB

DJ0165



Dimension

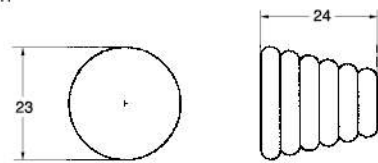

Description ຊື່	Material ວັດຖຸ
DJ0165	Stainless Steel SUS 304 / ສະເຕນເລດ 304 Brass / ກອງເລື່ອງ Steel / ເຫຼັກ

Finish / ຜັ່ງ :



DJ0199



Dimension

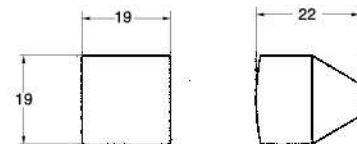

Description ຊື່	Material ວັດຖຸ
DJ0199	Zinc Alloy No.3 / ສິງຄ໌ອັລອຍ ເລວ໌ 3

Finish / ຜັ່ງ :



DJ0200



Dimension

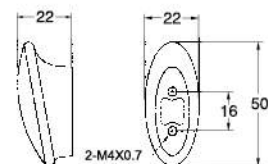

Description ຊື່	Material ວັດຖຸ
DJ0200	Zinc Alloy No.3 / ສິງຄ໌ອັລອຍ ເລວ໌ 3

Finish / ຜັ່ງ :



KNOB

MA1



Dimension

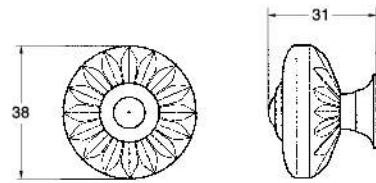

Description ຮຸ່ນ	Material ວັດຖຸ
MA1	Acrylic and Brass / ວະດິກປັດແລະທອງເຫຼືອງ

Finish / ຜ້ :



G

MK6



Dimension

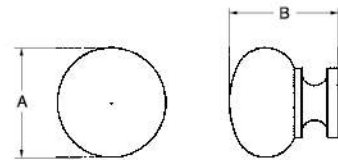

Description ຮຸ່ນ	Size / ພາກ		Material ວັດຖຸ
	A	B	
MA6	25	22	Stainless Steel SUS 304 ສະຕັນເລດ 304
	30	30	Brass / ທອງເຫຼືອງ Steel / ເຫຼັກ

Finish / ຜ້ :



AB

AC

HLNI

B-HL

C

CS

G

GHL

GS

N

NS

MK8



Dimension

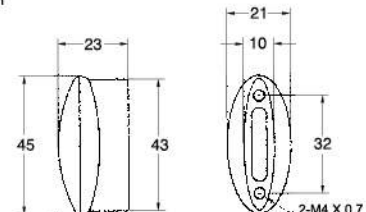

Description ຮຸ່ນ	Material ວັດຖຸ
MK8	Zinc Alloy No.3 / ສິງຄ໌ອັລລອຍ ແລກ໌ 3

Finish / ຜ້ :



HLNI

G

GS

N

NS

KNOB

MK9



Dimension

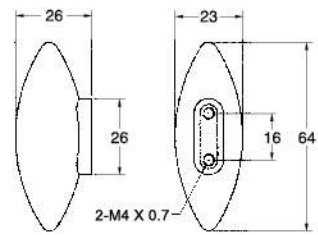

Description ຊື່	Material ວັສຸ
MK9	Zinc Alloy No.3 / ສິ່ງຄ້ວ້ລອຍ ແລະ 3

Finish / ຜ້ :



MK10



Dimension

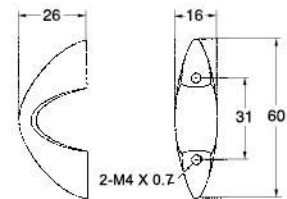

Description ຊື່	Material ວັສຸ
MK10	Zinc Alloy No.3 / ສິ່ງຄ້ວ້ລອຍ ແລະ 3

Finish / ຜ້ :

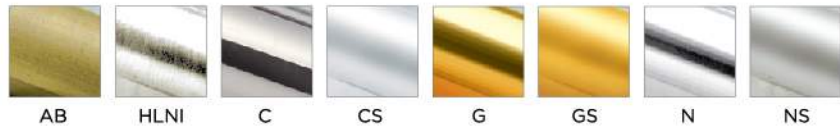

MK12



Dimension

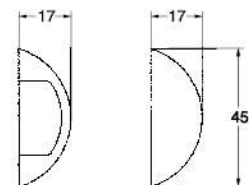

Description ຊື່	Material ວັສຸ
MK12	Zinc Alloy No.3 / ສິ່ງຄ້ວ້ລອຍ ແລະ 3

Finish / ຜ້ :

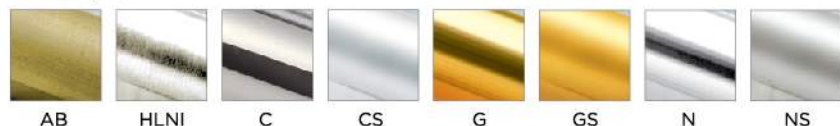

KNOB

No.127



Dimension

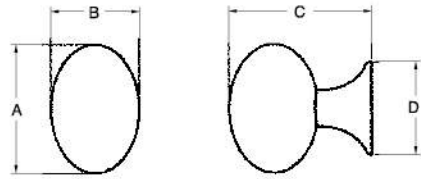

Description ຊື່	Size / ມມາດ				Material ວັດຖຸ
	A	B	C	D	
NO.127	25	17.5	28	18	Zinc Alloy No.3 ຮິງຄ໌ອັລລອຍ ແລກ໌ 3
	33	25	35	24	

Finish / ວິໄນ :



HLNI

B

C

G

GS

N

NS

No.2336



Dimension

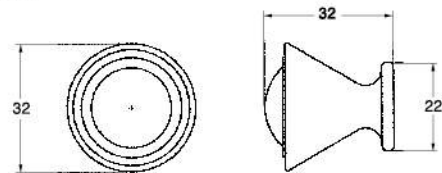

Description ຊື່	Material ວັດຖຸ
NO.2336	Brass / ພ້ອມເສື້ອ

Finish / ວິໄນ :



B-G

G-B

G-N

N-G

No.819



Dimension

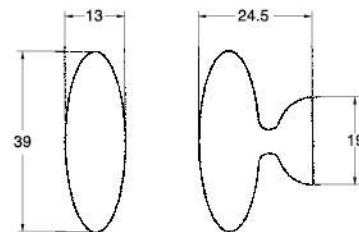

Description ຊື່	Material ວັດຖຸ
NO.819	Zinc Alloy No.3 / ຮິງຄ໌ອັລລອຍ ແລກ໌ 3

Finish / ວິໄນ :



HLNI

C

G

GS

N

NS

KNOB

No.8880 , No.8881



Dimension

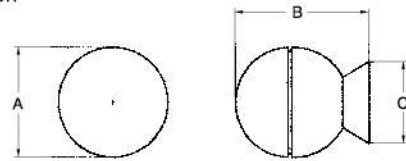

Description ຊື່	Size / ມມາດ			Material ວັດຖຸ
	A	B	C	
NO.8880	28	35	21	Brass or Steel ທອງເລື່ອງຫຼືເຫຼັກ
NO.8881	25	30	19	

Finish / ຜ້ :



PBL339



Dimension

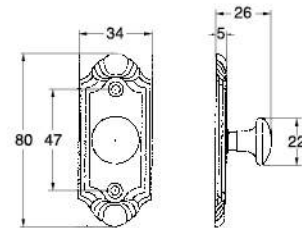

Description ຊື່	Material ວັດຖຸ
PBL339	Zinc Alloy No.3 / ອັງຄິດລາຍ ແທນ 3

Finish / ຜ້ :

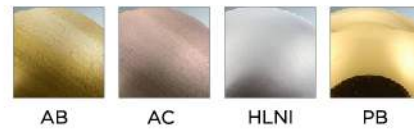

PK1



Dimension

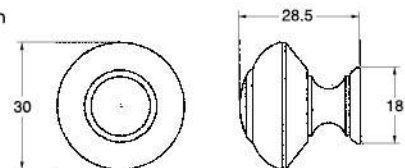

Description ຊື່	Size ມມາດ	Material ວັດຖຸ
PK1	30 mm.	Brass or Steel / ທອງເລື່ອງຫຼືເຫຼັກ

Finish / ຜ້ :



KNOB

PK3



Dimension

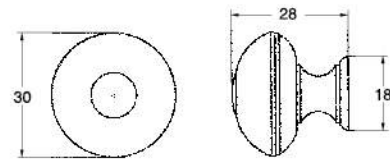

Description ຊື່	Size ໝາດ	Material ວັດຖຸ
PK3	30 mm.	Brass or Steel / ພັງເສື້ອນຫຼືເຮັດ

Finish / ຜ້ :

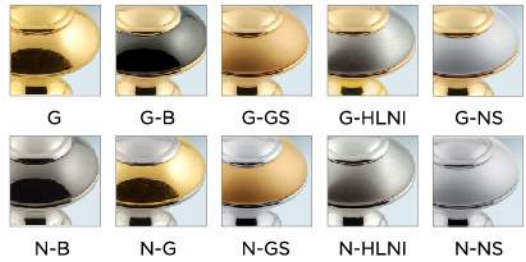

PK4



Dimension

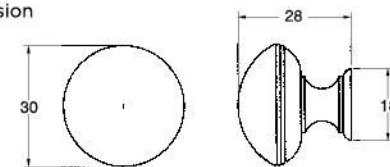

Description ຊື່	Size ໝາດ	Material ວັດຖຸ
PK4	30 mm.	Brass or Steel / ພັງເສື້ອນຫຼືເຮັດ

Finish / ຜ້ :

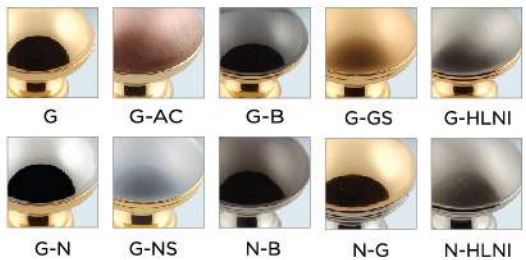

PK6



Dimension

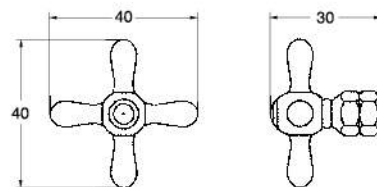

Description ຊື່	Size ໝາດ	Material ວັດຖຸ
PK6	40 mm.	Brass or Steel / ພັງເສື້ອນຫຼືເຮັດ

Finish / ຜ້ :



KNOB

PK7



Dimension

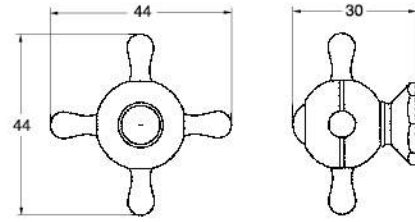

Description ຊື່	Size ໝາດ	Material ໄຊາດ
PK7	44 mm.	Brass or Steel / ພອງເລື້ອງຫຼືເນື້ອ

Finish / ັ້ :



G G-B G-GS G-HLNI N-HLNI

PK8



Dimension

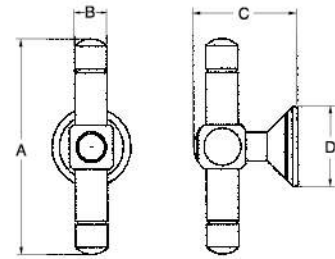

Description ຊື່	Size / ໝາດ				Material ໄຊາດ
	A	B	C	D	
PK8	60	9	29	22	Brass or Steel ພອງເລື້ອງຫຼືເນື້ອ
	90	11	36	30	

Finish / ັ້ :



AB G G-B G-GS G-HLNI N-HLNI

PK9



Dimension

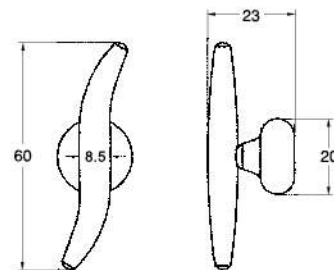

Description ຊື່	Size ໝາດ	Material ໄຊາດ
PK9	60 mm.	Brass or Steel / ພອງເລື້ອງຫຼືເນື້ອ

Finish / ັ້ :



G G-B G-GS G-HLNI

KNOB

PK10



Dimension

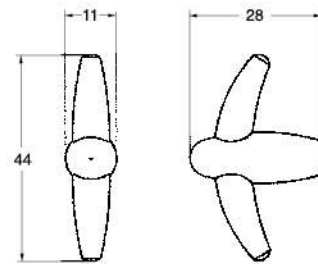

Description ຮຸ່ມ	Size ໝາດ	Material ວັດຖຸ
PK10	44 mm.	Brass or Steel / ກອງເລັ່ງຫຼືເຮັດເລັ່ງ

Finish / ຜ້າ :



G

G-B

G-GS

G-HLNI

N-HLNI

PK15



Dimension

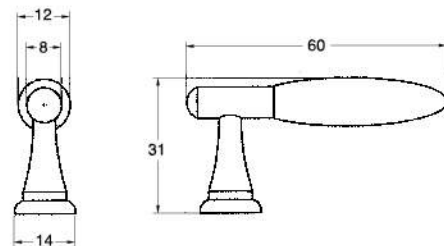

Description ຮຸ່ມ	Size ໝາດ	Material ວັດຖຸ
PK15	60 mm.	Brass or Steel / ກອງເລັ່ງຫຼືເຮັດເລັ່ງ

Finish / ຜ້າ :



C-CS

G-B

G-GS

G-HLNI

N-HLNI

MIRROR SCREW

GH1925



Dimension

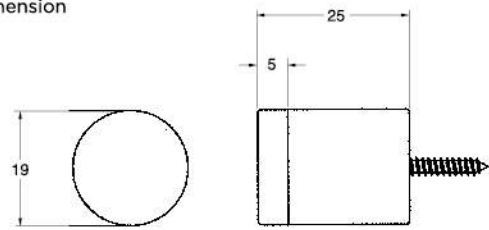

Description ຮູ	Size ໝາກ	Material ວັດຖຸ
GH1925	19 mm.	Stainless Steel SUS 304 ສະຕິນເລດສະ 304

Finish / ຜ້ :



SSHL

GH199 , GH259



Dimension

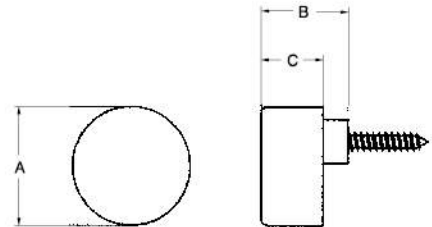

Description ຮູ	Size / ໝາກ			Material ວັດຖຸ
	A	B	C	
GH199	19	14	10	Brass / ຫຸ້ນເຫຼື້ອ
GH259	25	13	9	

Finish / ຜ້ :



HLNI

C

PB

CS

GH25



Dimension

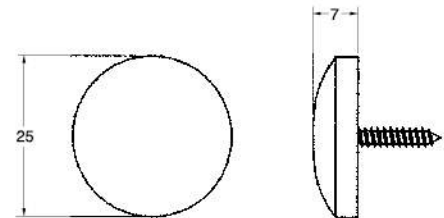

Description ຮູ	Size ໝາກ	Material ວັດຖຸ
GH25	25 mm.	Brass / ຫຸ້ນເຫຼື້ອ

Finish / ຜ້ :



HLNI

C

PB

CS